

News and Views

An occasional newsletter prepared by:
ALL ABOUT PLANNING PTY LTD
Corporate Members Planning Institute of Australia
Certified Practising Planners

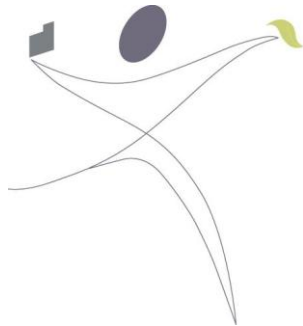

**ALL ABOUT
PLANNING**

PO BOX 2196
PORT MACQUARIE
NSW 2444
PH 02 6583 1305
FAX 02 6583 1368

CPP
CERTIFIED PRACTISING PLANNER

PIA Planning
Institute
Australia
Consultant Planners



Edition No. 9

We hope this edition of News and Views encourages you to think about some energy efficient initiatives you could adopt around your home or business and/or to get on your bike!

If you have been pleased with the service and professional work undertaken by All About Planning we would value your recommendation of our business to others.

Special Feature: Ecologically Sustainable Development

Energy Efficient Homes

A Mud Brick Home in The Hills Hits the Spot for Energy Efficiency and Home Comfort!

AAP staff were pleased to accept an invitation from Rupert G H Milne Home, Registered Landscape Architect, to experience the energy initiatives of his autonomous home near the village of Willawarrin, north west of Kempsey.



Some of the key energy initiatives in Rupert's house are:

- Self sufficiency in low-voltage Solar power for lighting, TV, stereo, computers and satellite internet connection
- Solar orientation of living areas to north east with passive thermal mass mudbrick construction & sustainable timber
- Total rainwater supply with solar and fuel-stove heated water



Photo: Rupert with Jazz the foal

Rupert says:

'The aim of the house was to be self sufficient in energy, water supply and sewerage disposal without compromising amenity and comfort.'

'For me, this has been achieved and I have enjoyed living this way since 1988.'

'It was much lower cost to establish than 'grid-connect' and is very low cost to run, with NO monthly electricity bills!'

For further information, technical or otherwise, please contact Rupert on rupla@harboursat.com.au or 02 6567 1384.

On Your Bike!



The NSW Government Bike Plan is released!

It is a blueprint for the development of local and regional bike plans and is good news for those of us who would love to see

more cycling opportunities locally.

If you have some time it is an interesting read...

Growing numbers of people are riding a bike in NSW: Do you have opportunity to join them?

With growing numbers of people riding a bike in NSW, many are finding out this is an affordable, practical and healthy option for everyday personal travel.
'Riding a bike can get you to your destination without the need to rely on a timetable, and with nearly no running costs.'

I,000 new homes per year for Hastings!

Port Macquarie-Hastings Council currently has their Draft Urban Growth Management Strategy on public exhibition until 10 September 2010.

Council anticipates an additional 31,000 persons are expected to live in the Port Macquarie-Hastings LGA by 2031, due almost entirely to net migration. This will take the total population to more than 100,000 people and will mean on average the area's population will grow by more than 1,000 persons per year over the next twenty years.



The strategy document sets out how this demand for housing and other land uses is to be met. As such the document is very significant and AAP encourages all our clients with property interests in the Hastings to check out Council's Strategy.

Please contact AAP if you would like us to assist you with this.

In the Media - \$20,000 Contributions Cap

A Section 94E NSW Ministerial Direction was released, effective 7 June 2010, which limits all NSW Councils to a maximum \$20,000 per dwelling Section 94 Contribution.

However, Council's can seek a special variation from the State Government, which may be granted depending on the merits of their case.

Recent Planning Work

- **Review of Environmental Factors for the RTA**
Oxley Highway, Sarahs Creek & King Creek



- **Statement of Environmental Effects**
Rural Tourist Facility in Kempsey Shire

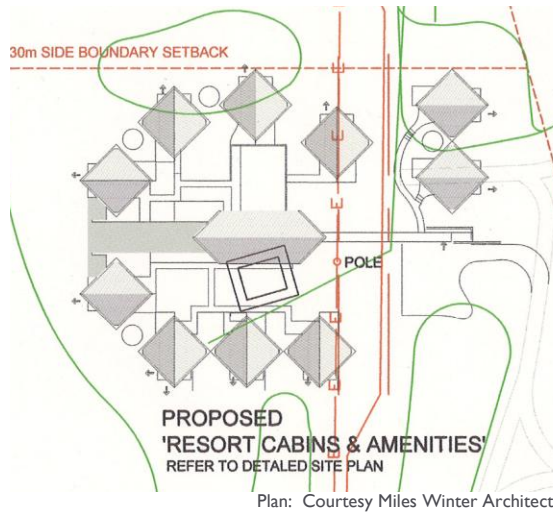

- **Section 96 Modification - 276 Home Site**
Manufactured Home Estate in Tamworth Shire
- **Draft Comprehensive DCP** (Development Control Plan)
for Warrumbungle Shire

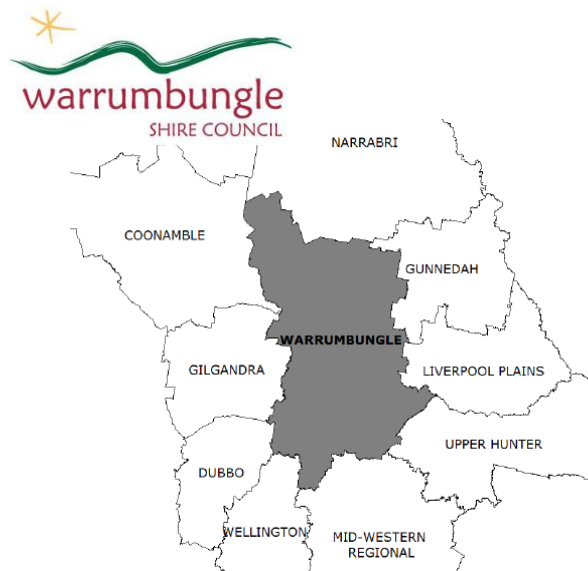

More Up Less Out

In previous editions of AAP's News & Views we have noted that managing population growth, an aging population and associated demand for housing is a real challenge for Government and Town Planners alike.

The economy of Australia is closely tied to population growth. In regional centres such as Port Macquarie, population growth is a key to local economic success and employment opportunities. If provision is not made for local population growth our area would certainly stagnate.



Picture source: AAP

Despite the fears and challenges, AAP hopes to see our local Council's strategic plans facilitating higher densities in well located established areas of Port Macquarie. Containing urban sprawl retains our valuable farm land, saves on infrastructure costs and creates more vibrant pedestrian focussed areas.

A note to our valued clients

One energy initiative that AAP has recently made is installing ceiling insulation. The ceiling insulation has raised our winter indoor temperature and saved us on heating costs.

As always, please feel free to call if you have any questions, need some planning advice or would like to provide us with feedback.

Best wishes to you,
Peter & Michelle
Chapman



For enquiries about how All About Planning can assist you, contact Peter or Michelle Chapman, your 100% Certified Practising Planners.

AAP Office: (02) 6583 1305
Peter: 0428 770 049
peter@allaboutplanning.com.au
Michelle: 0419 632 293
michelle@allaboutplanning.com.au